

# LSCENTER Instructions

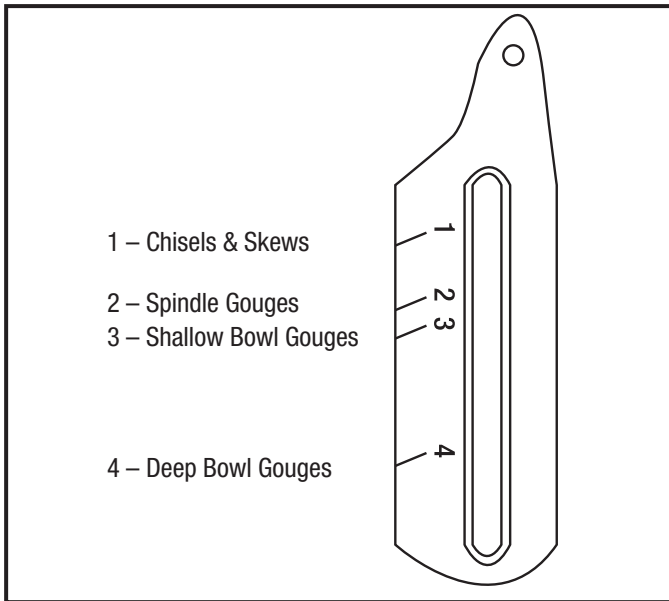

Fig. 1

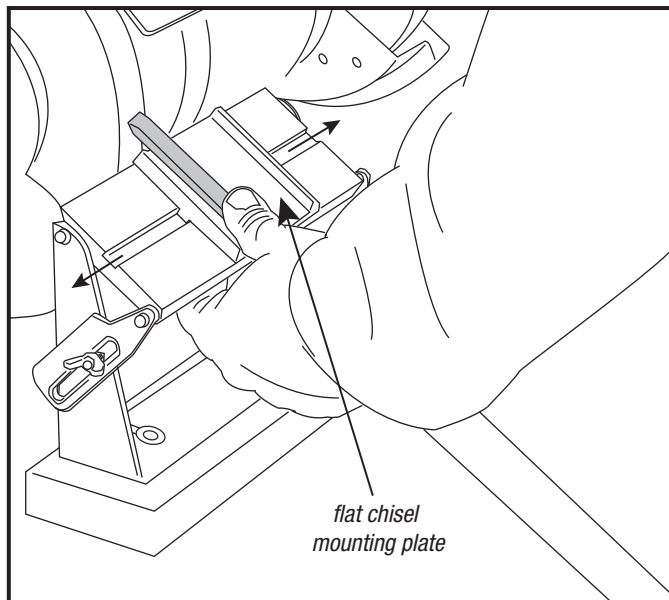

Fig. 2

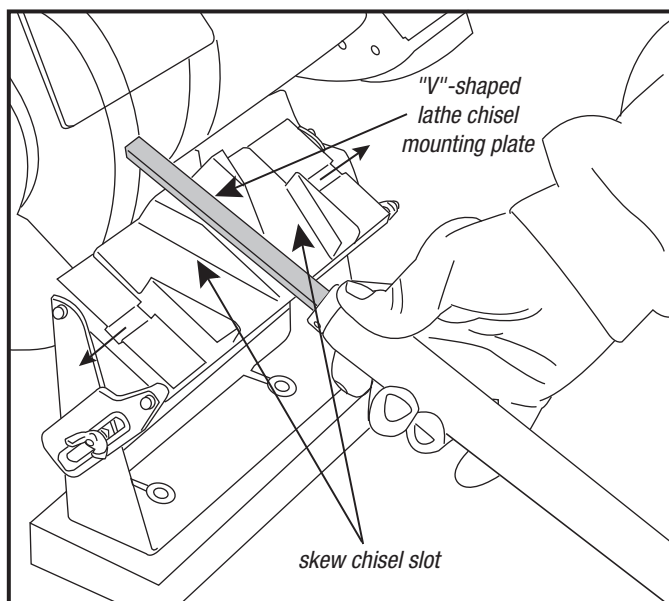

Fig. 3

- After removing jig and plates from box; mount base of jig to a piece of plywood, if necessary, consistent with the height of your grinder.
- Once mounted, place jig within 1/2" of grinding wheel. Then, place the plate needed on the jig for sharpening your tool. The flat plate is used on any tool that is flat. The "V"-shaped plate is used for any tool that is rounded or the tip is angled.
- After placing the proper plate in the center of the jig, look at either side of the jig. Loosen the wing nuts on both sides of the jig. One of the sides will have an angle gauge on the side (Fig. 1). Depending on your tool, line up the wing nut to the proper number to the tool you are planning to sharpen. See Fig. 1 or the top of your jig for proper setting for the tool you will be sharpening. Tighten the wing nuts on both sides.
- When using the flat plate, for cleaner blade edges, rest your thumb on top of the blade and grip the under side of the jig (Fig. 2). Apply an even pressure and sharpen as usual. If your tool can be sharpened on both sides, repeat this step.
- When using the "V"-shaped plate, for cleaner blade edges, rest your thumb on top of the chisel handle and grip the chisel firmly (Fig. 3). Apply an even pressure, rock slowly side to side, and sharpen as usual. If your tool can be sharpened on both sides, repeat this step.
- Use the angles on the "V"-shaped plate to sharpen skew chisels.
- **WARNING:** When chisels are being sharpened blades may become hot. Wear protective eyewear and gloves to assure safety during use.